

FORM No. 1.

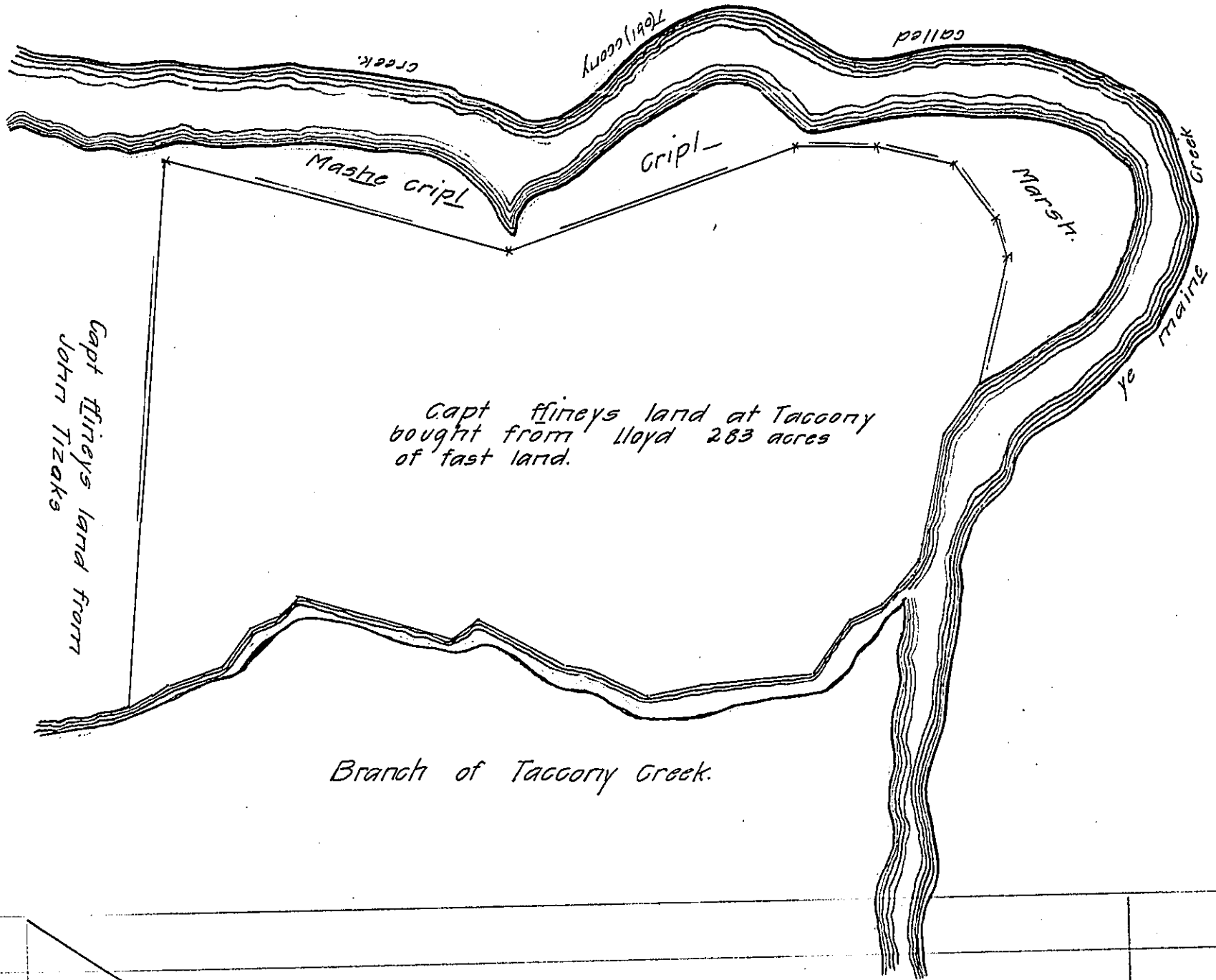

A large rectangular area with horizontal ruling lines, crossed out with a diagonal line from the top-left corner to the bottom-right corner.

IN TESTIMONY that the above is a copy of the original remaining on file in the Department of Internal Affairs of Pennsylvania, made conformably to an Act of Assembly approved the 16th day of February, 1833, I have hereunto set my Hand and caused the Seal of said Department to be affixed at Harrisburg, this twenty-second day of June 1909.

Henry Howell
 Secretary of Internal Affairs.